

Power Button

CONTENT

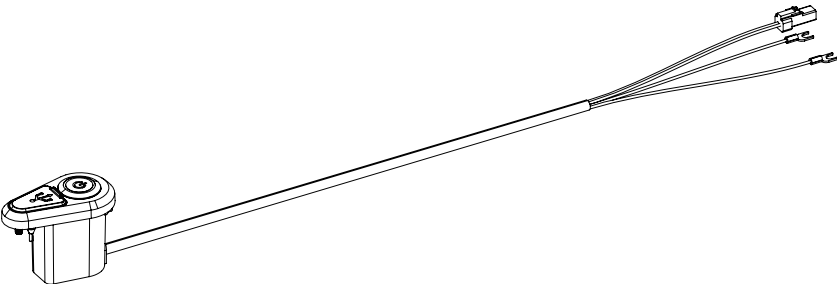

IMPORTANT NOTICE

- Contact the place of purchase or a distributor for information on installation, adjustment, and replacement of the products which are not found in the user's manual. A dealer's manual for professional and experienced bicycle mechanics is available on our website (<https://www.darfonenergy.com/tw/>).

For safety, be sure to read this “user's manual” thoroughly before use, follow it for correct use, and store it so that it can be referenced at any time.

- The following instructions must be observed at all times in order to prevent personal injury and physical damage to equipment and surroundings. The instructions are classified according to the degree of danger or damage which may occur if the product is used incorrectly.

DANGER	Failure to follow the instructions will result in death or serious injury.
WARNING	Failure to follow the instructions could result in death or serious injury.
CAUTION	Failure to follow the instructions could cause personal injury or physical damage to equipment and surroundings.

IMPORTANT SAFETY INFORMATION

CAUTION

- Do not disassemble or modify the product. This may cause the product not to operate correctly, and you may thus get injured.

NOTICE

- Please always keep the charge port cap well-covered while not using it.
- Do not pin the wire cable or pull it with excessive force.

INSTALL THE POWER BUTTON

- Ensure cable wires pass through the frame tube.

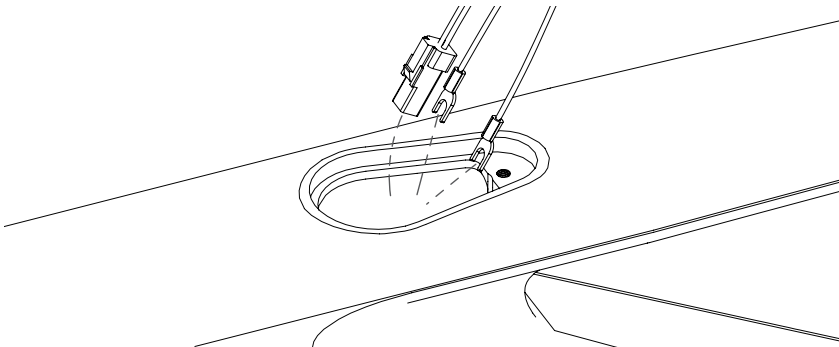

- Install the main body in slope angle into the frame. Fix the point A into the frame, and then flatten point B into the frame.

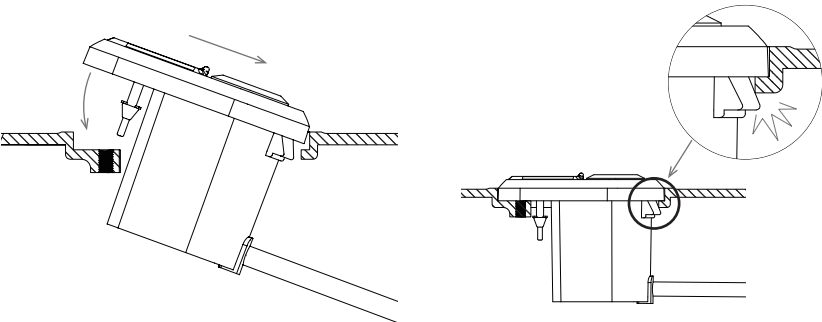

- Open the rubber cap and tighten the screws to the frame.

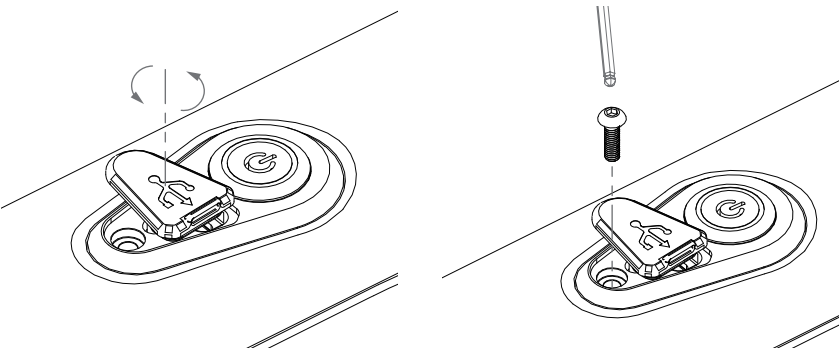

- Match the connector on the button cable with the corresponding connector on the mount.

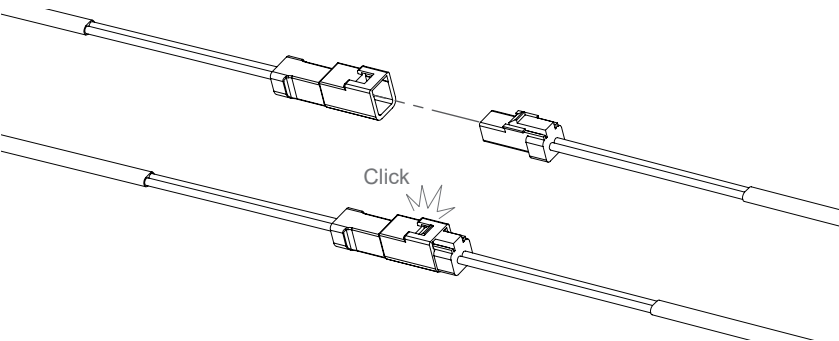

- Install the Y terminal (Red and Black wires) into the ACC slot of the motor.
Red terminal connect to “+”
Black Terminal connect to “-”

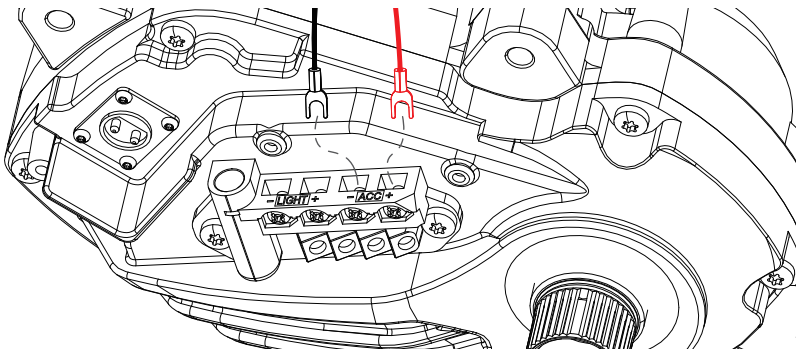

TROUBLESHOOTING

Details	Causes / possibilities	Remedy
Button malfunction	<ul style="list-style-type: none">• Wire broken?• Connector loosening?• Foreign matter inside the button?	<ul style="list-style-type: none">• Contact the place of purchase.• Install the connector again.• Clean the area around button.
USB charger malfunction	<ul style="list-style-type: none">• Water enters the USB port?• Faulty wiring?• Wire broken?	<ul style="list-style-type: none">• Check after dring the USB port. If not working, contact your supplier.• Correct wire connection.• Contact the place of purchase.
Rubber cap missing or damaged.	<ul style="list-style-type: none">• Assemble or use incorrectly ?	<ul style="list-style-type: none">• Contact the place of purchase.

DARFON
DARFON ENERGY TECH



Darfon Energy Technology Corp.
7 F., No. 167-1, Shanying Rd., Guishan Dist., Taoyuan City 333017, Taiwan (R.O.C.)

Darfon Electronics Czech s.r.o
Cvrcovice 192, 691 23 Cvrcovice. Czech Republic.

Please note: specifications are subject to change for improvement without notice. (English)
© May 2024 by Darfon Energy Technology Corp.

5J.E4C0G.0B1

